

SHARP®

LC-40LE530M
LC-46LE530M
LC-60LE630M

เครื่องโทรทัศน์จอภาพแอลซีดี
LCD COLOUR TELEVISION

คู่มือการใช้งาน
OPERATION MANUAL

AQUOS



SRS 
TruSurround HD

**FULL
HD 1080P**

DLX
HD

HDMI

DOLBY
DIGITAL

LED

ภาษาไทย

ENGLISH

Dear SHARP customer

Thank you for your purchase of the SHARP LCD colour TV product. To ensure safety and many years of trouble-free operation of your product, please read the Important Safety Precautions carefully before using this product.

Contents

	Page		Page
Dear SHARP customer.....	1	Menu operation.....	11
Supplied accessories.....	1	Picture menu.....	11
Important Safety Precautions	2	Audio menu.....	12
Trademarks.....	2	ECO menu	12
Attaching the stand unit – 40/46LE530M.....	3	Setup menu	13
Attaching the stand unit – 60LE630M	4	Option menu	14
Angle adjustment (only for 40/46LE530M)	5	Picture and still image	15
Setting the TV	5	Wide Mode	15
Connecting external devices.....	6	Teletext function.....	16
Remote control unit	7	PC compatibility chart	16
Part names.....	8	USB media player	17
Turning the TV on/off	8	Appendix	21
Initial auto installation.....	9	Specifications	22
Auto installation.....	9	Removing the stand – 40/46LE530M	23
Programme setup.....	9	Removing the stand – 60LE630M.....	23
Selecting a preset AV mode	10	Mounting the TV on a wall.....	24

ENGLISH

Supplied accessories

Remote control unit



“AA” size battery (×2)



Operation manual



Stand unit

LC-40LE530M

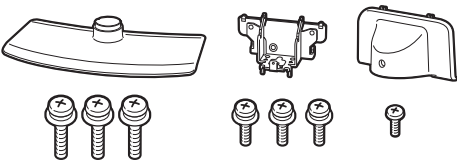

LC-46LE530M

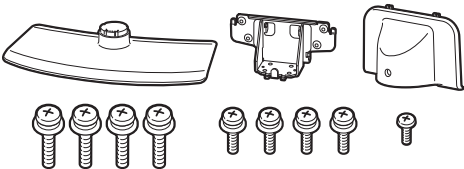

LC-60LE630M

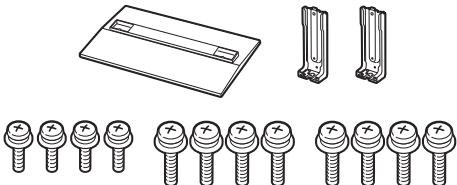

Important Safety Precautions

- **Cleaning** — Unplug the AC cord from the AC outlet before cleaning the product. Use a soft damp cloth to clean the product. Do not use liquid cleaners, aerosol cleaners or chemical cloth to clean it, as such materials may damage the product.
- **Water and moisture** — Do not use the product near water, such as bathtub, washbasin, kitchen sink, laundry tub, swimming pool and in a wet basement.
- **Do not place vases or any other water-filled containers on this product.**
The water may spill onto the product causing fire or electric shock.
- **Stand** — Do not place the product on an unstable cart, stand, tripod or table. Doing so can cause the product to fall, resulting in serious personal injuries as well as damage to the product. Use only a cart, stand, tripod, bracket or table recommended by the manufacturer or sold with the product. When mounting the product on a wall, be sure to follow the manufacturer's instructions. Use only the mounting hardware recommended by the manufacturer.
- **When relocating the product placed on a cart, it must be moved with utmost care.** Sudden stops, excessive force and uneven floor surface can cause the product to fall from the cart.
- **Ventilation** — The vents and other openings in the cabinet are designed for ventilation. Do not cover or block these vents and openings since insufficient ventilation can cause overheating and/or shorten the life of the product. Do not place the product on a bed, sofa, rug or other similar surface, since they can block ventilation openings. This product is not designed for built-in installation; do not place the product in an enclosed place such as a bookcase or rack, unless proper ventilation is provided or the manufacturer's instructions are followed.
- **The LCD panel used in this product is made of glass.** Therefore, it can break when the product is struck forcefully or with a sharp object. If the LCD panel is broken, be careful not to be injured by broken glass.
- **Heat sources** — Keep the product away from heat sources such as radiators, heaters, stoves and other heat-generating products (including amplifiers)
- **To prevent fire, never place any type of candle or naked flames on the top or near the TV set.**
- **To prevent fire or shock hazard, do not place the AC power cord under the TV set or other heavy items.**
- **Do not place heavy objects on this product or stand on it.** Doing so could cause injury if the product overturns. Take special care near children and pets.
- **The LCD panel is a very high technology product with 2,073,600 pixels, giving you fine picture details.**
Due to the very large number of pixels, occasionally a few non-active pixels may appear on the screen as a fixed point of blue, green or red.
This is within product specifications and does not constitute a fault.

• **Precautions when transporting the TV**

When transporting the TV, never carry it by holding or otherwise putting pressure onto the display. Be sure to always carry the TV by two people holding it with two hands — one hand on each side of the TV.

- **Do not display a still picture for a long time, as this could cause an afterimage to remain.**
- **Install the product on the place where the AC cord can be unplugged easily from the AC outlet, or from the AC INPUT terminal on the rear of the product.**

Trademarks

- TruSurround HD, SRS and  symbol are trademarks of SRS Labs, Inc. TruSurround HD technology is incorporated under license from SRS Labs, Inc.
- SRS TruSurround HD™ creates an immersive, feature-rich surround sound experience from two speakers, complete with rich bass, high frequency detail and clear dialog.

- HDMI, the HDMI logo, and High-Definition Multimedia Interface are trademarks or registered trademarks of HDMI Licensing LLC in the United States and other countries.

- DivX®, DivX Certified® and associated logos are trademarks of Rovi Corporation or its subsidiaries and are used under license.

- **ABOUT DIVX VIDEO:** DivX® is a digital video format created by DivX, LLC, a subsidiary of Rovi Corporation. This is an official DivX Certified® device that plays DivX video. Visit divx.com for more information and software tools to convert your files into DivX videos.
- **ABOUT DIVX VIDEO-ON-DEMAND:** This DivX Certified® device must be registered in order to play purchased DivX Video-on-Demand (VOD) movies. To obtain your registration code, locate the DivX VOD section in your device setup menu. Go to vod.divx.com for more information on how to complete your registration.

- Manufactured under license from Dolby Laboratories.
Dolby and the double-D symbol are trademarks of Dolby Laboratories.

Attaching the stand unit — 40/46LE530M

- Before performing work, spread cushioning over the surface on which you will be laying the TV. This will prevent it from being damaged.

CAUTION

- Attach the stand in the correct direction.
- Be sure to follow the instructions. Incorrect installation of the stand may result in the TV falling over.

- Confirm that there are screws with the stand unit.

For 40 inch models

(three long screws, three middle screws and one short screw)



For 46 inch models

(four long screws, four middle screws and one short screw)



- Attach the supporting post for the stand unit onto the base using the long screws with a screwdriver as shown.

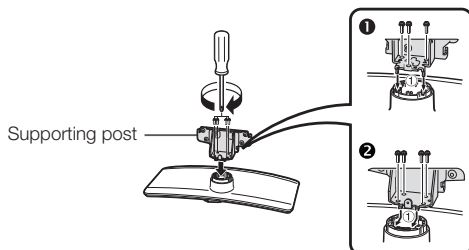

- 40 inch models
- 46 inch models

- Insert the stand into the openings on the bottom of the TV (hold the stand so it will not drop from the edge of the base area).

Soft cushion

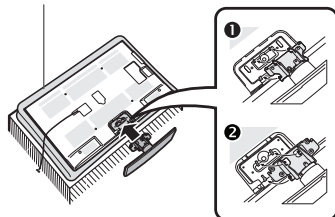

- 40 inch models
- 46 inch models

- Insert and tighten middle screws into the holes on the rear of the TV.

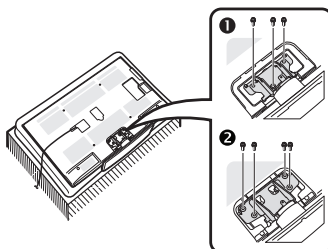

- 40 inch models
- 46 inch models

- Attaching the stand cover.

- Insert the stand cover.
- Insert and tighten a short screw into the hole of the stand cover.

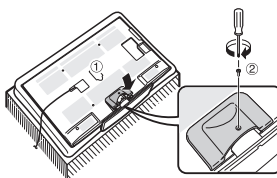

NOTE

- To detach the stand unit, perform the steps in reverse order.
- A screwdriver is not supplied with this product.

Attaching the stand unit — 60LE630M

- Before performing work, spread cushioning over the surface on which you will be laying the TV. This will prevent it from being damaged.

CAUTION

- Attach the stand in the correct direction.
- Be sure to follow the instructions. Incorrect installation of the stand may result in the TV falling over.

- Confirm that there are screws with the stand unit.

**For 60 inch models
(Eight long screws and four short screws)**

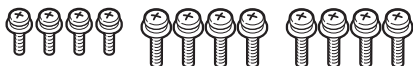

- Attach the supporting post for the stand unit onto the base using the long screws with a screwdriver as shown.

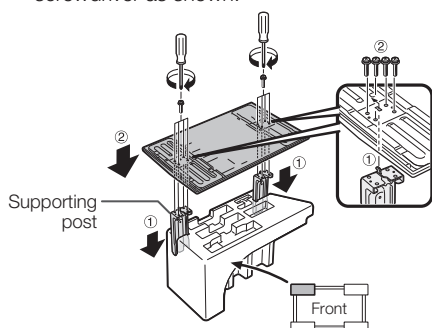

- Insert the stand into the openings on the bottom of the TV (hold the stand so it will not drop from the edge of the base area).

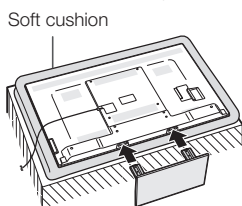

- Attaching the stand cover.

- Insert the stand cover.
- Insert and tighten four short screws into the holes of the stand cover.

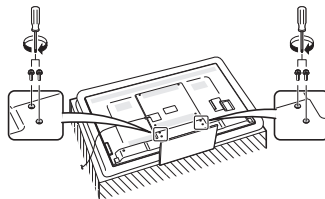

NOTE

- To detach the stand unit, perform the steps in reverse order.
- A screwdriver is not supplied with this product.

Angle adjustment (only for 40/46LE530M)

The TV can be rotated up to 15 degrees to the right or left.

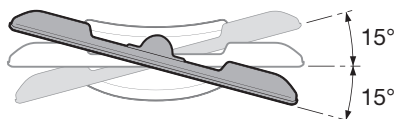

Front

CAUTION

- Adjust the screen with both hands. Place one hand on the TV and rotate the screen while holding the bottom of the stand (the black part in the above illustration) with your other hand.

Setting the TV

Connecting the antenna cable

To enjoy a clearer picture, use an outdoor antenna.

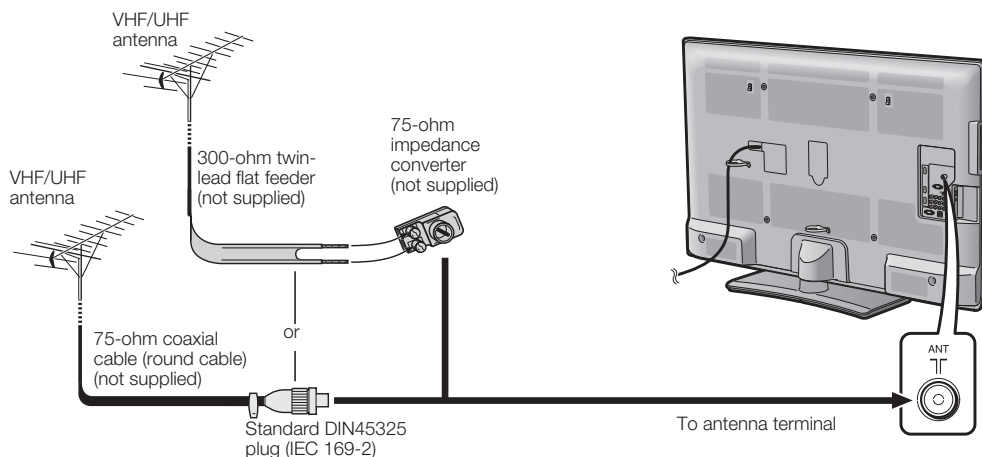

If your outdoor antenna uses a 75-ohm coaxial cable with a standard DIN45325 plug (IEC 169-2), plug it into the antenna jack at the rear of the set.

If your outdoor antenna uses a 300-ohm twin-lead flat feeder, connect a 300-ohm to 75-ohm impedance converter and plug it into the antenna jack at the rear of the set.

CAUTION

- TO PREVENT RISK OF ELECTRIC SHOCK, DO NOT TOUCH UN-INSULATED PARTS OF ANY CABLES WITH THE AC CORD CONNECTED.**

The illustrations used throughout this manual are based on LC-46LE530M.

Connecting external devices

You can connect many types of external equipment to your TV, like a VCR, game console, camcorder, DVD player, Digital TV STB (Set Top Box) and PC. To view external source images, select the input source from **INPUT** on the remote control unit or **INPUT** on the TV.

CAUTION

- To protect all equipment, always turn off the TV before connecting to a VCR, game console, camcorder, DVD player, Digital TV STB (Set Top Box), PC or other external equipment.
- Refer to the relevant operation manual (VCR, DVD player, etc.) carefully before making connections.

Connecting a VCR, game console or camcorder

A VCR, game console, camcorder and some other audiovisual equipment can be conveniently connected using the INPUT 4/INPUT 5 or INPUT 6 terminals.

When using composite cable (commercially available)

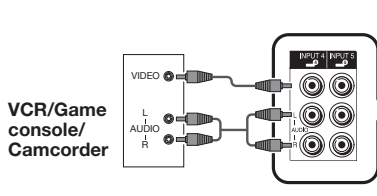

When using component cable (commercially available)

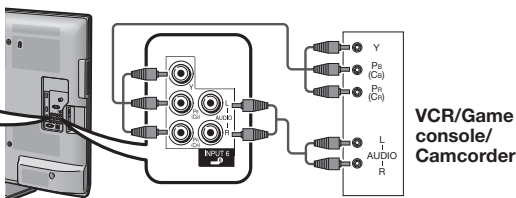

Connecting a DVD player/Digital TV STB (Set Top Box)

You can use the HDMI 1/HDMI 2/HDMI 3, INPUT 6 terminals when connecting to a DVD player/Digital TV STB (Set Top Box) and other audiovisual equipment.

When using HDMI-certified cable (commercially available)

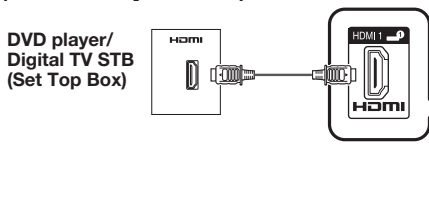

When using component cable (commercially available)

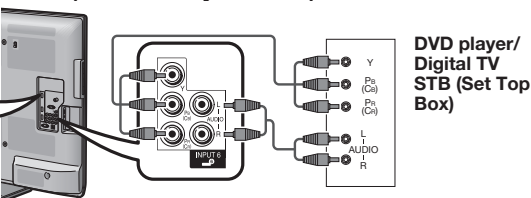

Connecting a PC

You can use the PC terminals when connecting to a PC.

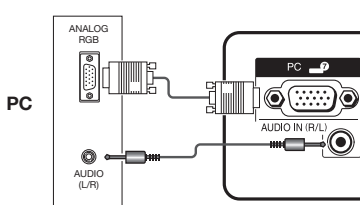

Using Digital Audio Output

It is possible to output audio through the DIGITAL AUDIO OUTPUT terminal. PCM audio outputs from the terminal.

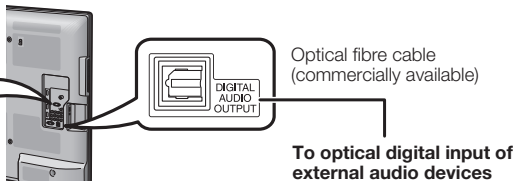

NOTE

- The DIGITAL AUDIO OUTPUT terminal usually outputs the same audio from the speakers. (The audio of the content you are viewing is output from the terminal.)
- The DIGITAL AUDIO OUTPUT terminal does not output some signals, depending on devices and software.

• The illustrations used throughout this manual are based on LC-46LE530M.

Remote control unit

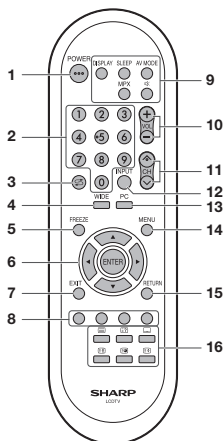

SLEEP

Set the Sleep timer.

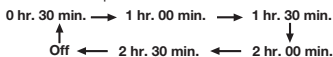

AV MODE

Select an audio and video setting. (See page 10.)

MPX

Select the sound multiplex mode.

Mute

Press → Mutes sound.

Press again → Restores sound.

Mute will be cancelled after 30 minutes. However, the TV will not suddenly output loud sound as the volume level will be set to 0 automatically. Increase the volume level by pressing **VOL +**.

10 VOL + /VOL -

Set the volume.

(VOL +) Increase the volume.

(VOL -) Decrease the volume.

11 CH▲/CH▼

TV input mode: Select the channel.

(CH▲) Increase the channel number.

(CH▼) Decrease the channel number.

TELETEXT mode: Select the page. (See page 16.)

12 INPUT (INPUT SOURCE)

Select an input source.

13 PC

Directly select the PC terminal.

14 MENU

Display the menu screen.

15 RETURN

MENU mode: Return to the previous menu screen.

16 (TELETEXT)

Select the TELETEXT mode. (all TV image, all TEXT image, TV/TEXT image) (See page 16.)

(Reveal hidden for TELETEXT)

TELETEXT mode: Display hidden characters. (See page 16.)

(SUBTITLE for TELETEXT)

To turn the subtitles on. (See page 16.)

(Hold)

TELETEXT mode: Stop updating Teletext pages automatically. Press again to release the hold mode. (See page 16.)

(Subpage)

Display the Teletext subpage directly when in Teletext mode. (See page 16.)

(Top/Bottom/Full)

TELETEXT mode: Set the area of magnification. (See page 16.)

1 POWER (STANDBY/ON)

To switch the power on and off. (See page 8.)

2 0 - 9

Set the channel.

TELETEXT mode: Set the page. (See page 16.)

3 (Flashback)

Press to return to the previous selected channel or external input mode.

4 WIDE

Change the wide image mode. (See pages 15 and 16.)

5 FREEZE

Freeze a motion picture on the screen. (See page 15.)

6 ▲/▼/◀/▶ (Cursor)

Select a desired item on the setting screen.

ENTER

Execute a command.

7 EXIT

Return to the default screen.

8 Colour (Red/Green/Yellow/Blue)

TELETEXT mode: Select a page. (See page 16.)

9 DISPLAY

Display the channel or input information.

Inserting the battery

Before using the TV for the first time, insert a "AA" size battery (supplied). When the battery become depleted and the remote control fails to operate, replace the battery with new "AA" size battery.

- 1 Open the battery cover.
- 2 Insert the supplied "AA" size battery.
- 3 Close the battery cover.

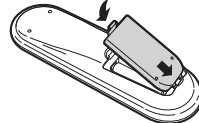
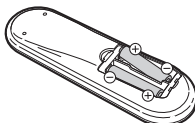
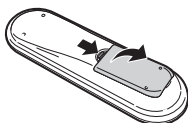

- Place battery with their terminals corresponding to the (+) and (-) indications in the battery compartment.

CAUTION

- Battery (battery pack or battery installed) shall not be exposed to excessive heat such as sunshine, fire or the like.
- Do not mix batteries of different types.
- Do not mix old and new batteries.

Part names

TV (Front)

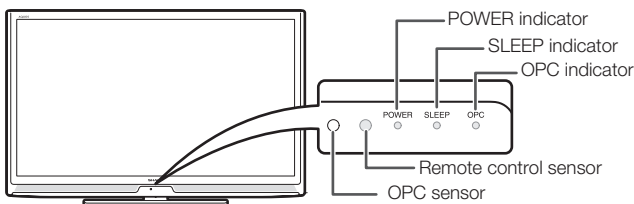

Light off	Power off
Lighted (Red)	The TV is in standby mode.
Lighted (Green)	The TV is on.

TV (Rear)

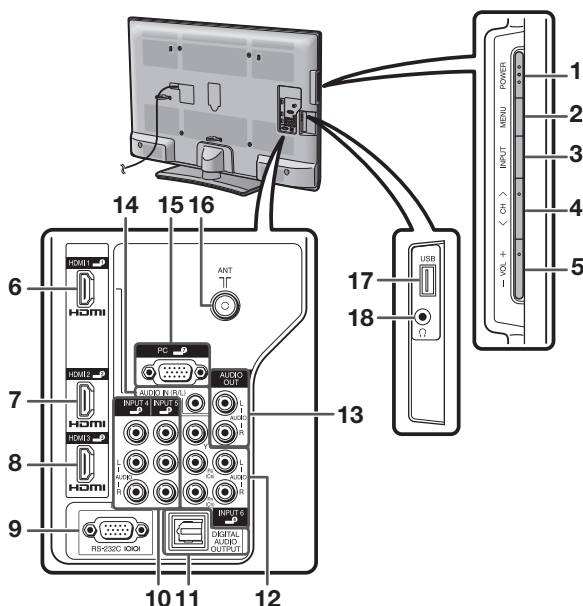

- 1 **POWER** (On/Off) button
- 2 **MENU** button
- 3 **INPUT** button
- 4 Channel up (▲)/down (▼) buttons
- 5 Volume up (+)/down (-) buttons
- 6 HDMI 1 terminal*
- 7 HDMI 2 terminal
- 8 HDMI 3 terminal
- 9 RS-232C terminal
- 10 INPUT 4/INPUT 5 terminals
- 11 DIGITAL AUDIO OUTPUT terminal
- 12 INPUT 6 terminals
- 13 AUDIO OUT terminals
- 14 AUDIO IN (R/L) terminal
- 15 PC terminals*
- 16 Antenna input terminal
- 17 USB terminal
- 18 Headphone jack (ø 3.5 mm)
 - The speakers do not output volume when headphones are plugged in.

* The HDMI1 and PC terminals can both use the same audio input terminal. However, the proper item must be selected in the "PC audio select" menu. (See page 14.)

- The illustrations in this operation manual are for explanation purposes and may vary slightly from the actual operations.
- The illustrations used throughout this manual are based on LC-46LE530M.

Turning the TV on/off

Turning on/off the power

- **To turn on the power**
Press **POWER** on the TV. (After a few seconds, an image appears with sound.)
- **To turn off the power**
Switch it off by pressing **POWER** on the TV.

Standby mode

- **To standby mode**
If the TV is switched on, you can switch it to standby by pressing **POWER** on the remote control.
- **Switching on from standby**
From standby, press **POWER** on the remote control.

NOTE

- If you are not going to use this TV for a long period of time, be sure to remove the AC cord from the AC outlet.
- Minor power is consumed when the unit is in standby mode.

Initial auto installation

When the TV powers on for the first time after purchase, the initial auto installation wizard appears. Follow the menus and make the necessary settings one after another.

- 1 Press **POWER** on the TV.
 - The initial auto installation wizard appears.
- 2 Press **▲/▼/◀/▶** to select the desired language, and then press **ENTER**.
- 3 Press **◀/▶** to select “HOME” or “STORE”, and then press **ENTER**. Press **▲/▼** to select the desired sound system, and then press **ENTER**.
 - Auto installation will be executed.
 - You do not need to do anything during the auto search.

NOTE

- HOME mode: Settings are optimised for normal home viewing and energy efficiency.
- STORE mode: Settings are designed for maximum impact in retail store displays.
- To change the STORE mode to HOME mode, please refer to page 14 to reset the unit.

Auto installation

You can run auto installation again, even after setting up the preset channels.

- 1 Press **MENU** and the MENU screen displays.
- 2 Press **◀/▶** to select “Setup”.
- 3 Press **▲/▼** to select “Auto installation”, and then press **ENTER**.
- 4 If you have already set the password, enter it here.
 - See page 13 for setting a password.

- - - -
- 5 Press **◀/▶** to select “Yes”, and then press **ENTER**.
- 6 Press **▲/▼/◀/▶** to select the desired language listed on the screen, and then press **ENTER**. Press **▲/▼** to select the desired sound system, and then press **ENTER**. You do not need to do anything during the auto search. Press **MENU** to exit.

Programme setup

Auto search

You can also automatically search by performing the procedure below. This is the same function as programme auto search in auto installation.

- 1 Press **MENU** and the MENU screen displays.
- 2 Press **◀/▶** to select “Setup”.
- 3 Press **▲/▼** to select “Programme setup”, and then press **ENTER**.
- 4 If you have already set the password, enter it here.
 - See page 13 for setting a password.

- - - -
- 5 Press **▲/▼** to select “Auto search”, and then press **ENTER**.
- 6 Press **◀/▶** to select “Yes”, and then press **ENTER**. Press **▲/▼** to select the desired sound system, and then press **ENTER**. You do not need to do anything during the auto search. Press **MENU** to exit.

Manual adjust

You can set some channel item manually.

- 1 Repeat steps 1 to 4 in **Auto search**.
- 2 Press **▲/▼** to select “Manual adjust”, and then press **ENTER**.
- 3 Press **◀/▶** to select “Yes”, and then press **ENTER**.
- 4 Press **▲/▼/◀/▶** to select the channel you want to edit, and then press **ENTER**.
 - The selected channel information displays.
- 5 Press **▲/▼** to select the desired menu, and then press **ENTER**.
- 6 Press **▲/▼** or **◀/▶** to select the desired item or adjust the item to the desired level. Press **ENTER** if necessary.

Search

The next channel will be search in order.

Fine

You can adjust the frequency to your desired position.

NOTE

- Adjust while checking the background picture as a reference.
- Instead of pressing **◀/▶** to adjust the frequency, you can set by directly entering the frequency number of the channel with **0 - 9**.

Programme setup (Continued)

EXAMPLE

- 179.25 MHz: Press **1** → **7** → **9** → **2** → **5**.
- 49.25 MHz: Press **4** → **9** → **2** → **5** → **ENTER**.

■ Colour system

Select the optimum colour system to receive. (Auto, PAL, SECAM, NTSC 3.58, NTSC 4.43, PAL-60)

■ Sound system (Broadcasting system)

Select the optimum sound system (Broadcasting system) to receive. (B/G, D/K, I, M)

■ Label

To enter the name of the channel. Maximum 5 alphanumeric can be input.

Press **▲/▼/◀/▶** to select each character of the new name for the channel, and then press **ENTER**. Repeat until the name is fully spelt out.

- When you want to set a channel name of less than 5 characters, select "END".

■ Booster

Enhance the picture quality during weak signal. It is not recommended to turn on during strong signal condition. It may induced unwanted noise. (On, Off)

■ Skip

Channels with "Skip" set to "On" are passed over when using **CH▲/▼** even if selected while watching the image from the TV.

■ Lock

You can block the viewing of any channel.

NOTE

- See "Child lock" for setting a password.
- If "Lock" is set to "On" for a channel, "Child lock has been activated." is displayed when you select the channel, and the image and sound of the channel is blocked.
- When pressing **ENTER** while "Child lock has been activated." is displayed, password input menu will be displayed. Inputting the correct password lifts the child lock temporarily until the power is turned off.

Sort

Channel position can be sorted freely.

- 1 Repeat steps 1 to 4 in **Auto search**.
- 2 Press **▲/▼** to select "Sort", and then press **ENTER**.
- 3 Press **◀/▶** to select "Yes", and then press **ENTER**.
- 4 Press **▲/▼/◀/▶** to select the channel you want to move, and then press **ENTER**.

- 5 Move it to the desired position by pressing **▲/▼/◀/▶**, and then press **ENTER**.
- 6 Repeat the steps 4 and 5 until all desired channels are sorted.

Erase programme

The individual programme can be erased.

- 1 Repeat steps 1 to 4 in **Auto search**.
- 2 Press **▲/▼** to select "Erase programme", and then press **ENTER**.
- 3 Press **◀/▶** to select "Yes", and then press **ENTER**.
- 4 Press **▲/▼/◀/▶** to select the channel you want to erase, and then press **ENTER**.
- 5 Press **ENTER** to erase the channel.
- 6 Repeat the steps 4 and 5 until all desired channels are erased.

Selecting a preset AV mode

"AV mode" gives you several viewing options to choose from to best match the system environment, which can vary due to factors like room-brightness, type of programme watched or the type of image input from external equipment.

- 1 Press **AV MODE**.
- 2 Each time you press **AV MODE**, the mode changes.
 - You can also switch the mode in the "AV mode" menu on the "Picture" menu screen.

Selected item	Description
STANDARD	For a highly defined image in a normally bright room.
MOVIE	For a movie.
GAME	For game play.
PC	For PC. (Available only when inputting an HDMI or PC signal.)
USER	Allows the user to customise settings as desired. You can set the mode for each input source.
DYNAMIC (FIXED)	Changes the image and sound settings to the factory preset values. No adjustments are allowed.
DYNAMIC	For a clear-cut image emphasising high contrast for sports viewing.

NOTE

- You can select a different AV mode item for each input mode. (For example, select STANDARD for TV input and DYNAMIC for VIDEO input.)
- During PC input mode, only "STANDARD", "PC" and "USER" can be selected under the AV mode selection.

Menu operation

- 1 Press **MENU** and the MENU screen displays.
- 2 Press **◀/▶** to select the desired menu. (Picture, Audio, ECO, Setup, Option)
- 3 Press **▲/▼** to select the desired menu item. Press **ENTER** to proceed if necessary.
- 4 Press **▲/▼** or **◀/▶** to select the desired item or adjust the item to the desired level. Press **ENTER** if necessary.

Picture menu



■ OPC (Optical Picture Control) setting

You can set the TV to automatically adjust the screen to suitable backlight brightness according to the lighting conditions.

Selected item	Description
On:Display	Displays the OPC effect on the screen while adjusting the brightness of the screen.
On	Automatically adjusts.
Off	The brightness is fixed at the value set in "Backlight".

NOTE

- Make sure no object obstructs the OPC sensor, which could affect its ability to sense surrounding light.

■ Picture adjustments

Selected item	◀ button	▶ button
Backlight	The screen dims	The screen brightens
Contrast	For less contrast	For more contrast
Brightness	For less brightness	For more brightness
Colour	For less colour intensity	For more colour intensity
Tint	Skin tones become purplish	Skin tones become greenish
Sharpness	For less sharpness	For more sharpness

■ Advanced

Colour temp. (Colour temperature)

Adjusts the colour temperature to give the best white image.

Selected item	Description
High Mid-High Middle Mid-Low Low	White with bluish tone ↓ White with reddish tone

Quick shoot

Use Quick shoot to view fast-action images more clearly. (On, Off)

NOTE

- Quick shoot may cause image noise. If this occurs, set the function to "Off".

Film mode

Automatically detects a film-based source (originally encoded at 24/25 frames/second, depending on the vertical frequency), analyses it then recreates each still film frame for high-definition picture quality. (On, Off)

Active contrast

Automatically adjusts the contrast of an image according to the scene. (On, Off)

3D-Y/C

Provides high quality images with minimal dot crawl and cross colour noise. (On, Off)

NOTE

- 3D-Y/C is not selectable depending on the input signal type.
- 3D-Y/C may not operate depending on the input signal type or noisy input signal.

Monochrome

For viewing images in monochrome. (On, Off)

DNR (Digital Noise Reduction)

Reduces noise on screen and produces a clearer video image. (Off, High, Low, Auto)

NOTE

- For resetting all Picture adjustment items to factory preset values, press **▲/▼** to select "Reset", press **ENTER**, press **◀/▶** to select "Yes", and then press **ENTER**.

Audio menu

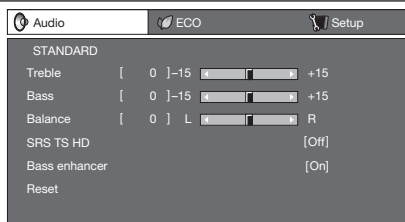

Audio adjustments

Selected item	◀ button	▶ button
Treble	For weaker treble	For stronger treble
Bass	For weaker bass	For stronger bass
Balance	Decrease audio from the right speaker	Decrease audio from the left speaker

SRS TruSurround (TS) HD™

You can enjoy SRS TruSurround HD™ sound, the same as you were in movie theatre.

Using SRS TS HD on the menu screen

You can produce SRS TruSurround HD™ effects from the "Audio" setting.

Selected item	Description
On	SRS TruSurround HD™ creates a high quality surround sound experience, when watching DVD movies and TV programmes broadcast in surround sound.
Off	Outputs the normal sound.

Bass enhancer powered by SRS Labs, Inc.

This function allows you to enjoy bass-enhanced sound.

Selected item	Description
On	Bass enhancer function is on.
Off	Outputs the normal sound.

NOTE

- For resetting all Audio adjustment items to the factory preset values, press ▲/▼ to select "Reset", press **ENTER**, press ◀▶ to select "Yes", and then press **ENTER**.

ECO menu

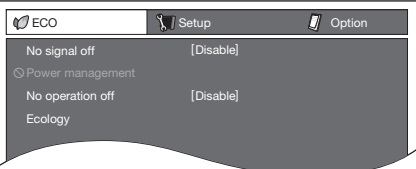

No signal off

You can set the TV to automatically power off in about 15 minutes after the TV goes into a state of receiving no programme signals, such as the end of a broadcast day. (Enable, Disable)

- Five minutes before the power shuts down, the remaining time displays every minute.

NOTE

- "Disable" is the factory preset value.
- When a TV programme finishes, and the TV receives signal input, this function may not operate.

Power management (PC input mode only)

You can set the TV to automatically power off when no image is displayed on PC.

Selected item	Description
Off	<ul style="list-style-type: none"> No power management Factory preset value.
Mode1	<ul style="list-style-type: none"> If no signal inputs for approximately 8 minutes, the power shuts down. Even if you start using the PC and the signal inputs again, the TV stays off. The TV turns on again by pressing POWER. (See page 8.)
Mode2	<ul style="list-style-type: none"> If no signal inputs for approximately 8 seconds, the power shuts down. When you start using the PC and the signal inputs again, the TV turns on. The TV turns on again by pressing POWER. (See page 8.)

No operation off

You can set the TV to automatically power off when no TV operation is performed for more than 3 hours. (30min., 3hr., Disable)

- Five minutes before the power shuts down, the remaining time displays every minute.

NOTE

- "Disable" is the factory preset value.

Ecology

When set to "Yes", the TV activates the following power saving mode.

- "OPC" set to "On" (Page 11)
- "No signal off" set to "Enable" (Page 12)
- "Power management" set to "Mode1" (Page 12)
- "No operation off" set to "3hr." (Page 12)
- "Quick start" set to "Off" (Page 14).

NOTE

- Ecology mode cannot be deactivated by selecting "No". Each setting must be changed individually to deactivate Ecology mode.

Setup menu

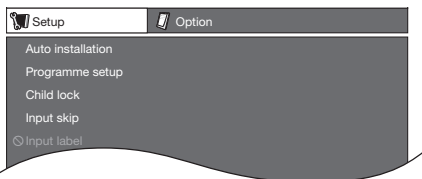

■ Child lock (TV input mode only)

Allows you to use a password to protect certain settings from being accidentally changed.

Setting a password

- 1 Repeat steps 1 to 2 in **Menu operation**.
- 2 Press **▲/▼** to select “Child lock”, and then press **ENTER**.
- 3 If you already set the password, enter it here.
- 4 Press **▲/▼** to select “Change password”, and then press **ENTER**.
- 5 Enter the 4-digit number as a password using **0 – 9**.

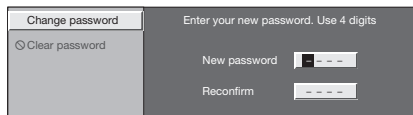

- 6 Enter the same 4-digit number as in step 5 to confirm.

NOTE

- To view a locked channel (Lock setting in Programme setup “Manual adjust” is set to “On”), you must enter a password. When you select a locked channel, “Child lock has been activated.” is displayed.
- Press **ENTER** to display the password input window.

Clearing the password

Allow you to clear your password.

- 1 Repeat steps 1 to 3 in **Setting a password**.
- 2 Press **▲/▼** to select “Clear password”, and then press **ENTER**.
- 3 Press **◀▶** to select “Yes”, and then press **ENTER**.

■ Input skip

This setting allows you to skip the HDMI or PC input on the input source selection operation.

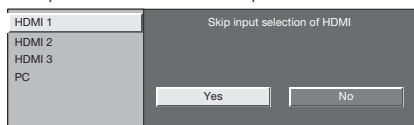

■ Input label

You can assign each input source a label as you prefer.

- 1 Press **INPUT** to select the desired input source.
- 2 Press **MENU** and the MENU screen displays.
- 3 Press **◀▶** to select “Setup”.
- 4 Press **▲/▼** to select “Input label”, and then press **ENTER**.
- 5 Press **▲/▼/◀▶** to select each character of the new name for the input source, and then press **ENTER**.
- 6 Repeat until the name is fully spelt out.
 - The name can be 6 characters or less.
 - When you want to set an input source name of less than 6 characters, select “END”, then press **ENTER** to exit from the labelling menu.

NOTE

- You cannot change labels if the input source is TV.

■ Position

For adjusting a picture’s horizontal and vertical position.

Selected item	Description
H-Position	Centres the image by moving it to the left or right.
V-Position	Centres the image by moving it up or down.

■ HDMI auto view (HDMI input mode only)

Selected item	Description
Enable/Disable	Set whether or not to use WIDE MODE based on signal recognition, including an HDMI signal.

■ WSS

WSS allows a television to switch automatically among the different screen formats. (On, Off)

NOTE

- Try to set WIDE mode if an image does not switch to the correct screen format. When the broadcast signal contains no WSS information, the function will not work even if enabled.
- Not available for COMPONENT, PC and HDMI signal.

■ 4:3 mode

The WSS signal has 4:3 auto-switching that allows you to select between Panorama and Normal.

Selected item	Description
Panorama	Wide image without side bars
Normal	Normal range keeping 4:3 or 16:9 aspect ratio

WSS signal 4:3 screen

4:3 mode “Panorama”



4:3 mode “Normal”



Setup menu (Continued)

NOTE

- You must set this to "PC" when connecting devices (including a PC) with an HDMI-certified cable to the HDMI 1 terminal. If "HDMI1" is set, there will be no sound output.

Output volume select

Allows you to select what controls the audio output.

Selected item	Description
Fixed	<ul style="list-style-type: none"> Sound via speakers is adjusted with VOL +/- on the remote control unit or the TV. Sound via the AUDIO OUT terminal is not adjustable and constantly outputs.
Variable	<ul style="list-style-type: none"> Sound via the AUDIO OUT terminal is adjusted with VOL +/- on the remote control unit or the TV. Sound via speakers is muted.

NOTE

- During "Output volume select" is set to "Variable", all Audio menu item cannot be adjusted.

Auto volume

Different sound sources, fairly often do not have the same volume level, for example the changing from movie to the advertisements. Auto volume solves this problem and equalises the volume levels.

(On, Off)

Clear voice

This function emphasises speech against background noise for greater clarity. (On, Off)

NOTE

- Clear voice only work when SRS TS HD is "On".

Digital audio output

This function allows you to select your favourite audio output system.

Selected item	Description
PCM	The optical output format is normally in PCM.
Dolby Digital	Dolby Digital audio will be output when there is a Dolby Digital audio signal. The output will be in PCM when there is no Dolby Digital audio signal.

Audio only

When listening to music from a music programme, you can set the display off and enjoy audio only.

Selected item	Description
On	Audio is output without screen image.
Off	Both screen images and audio are output.

NOTE

- When you make operations that change the picture on the TV such as by changing the input source, the Audio only function is set to "Off".

Quick start

You can reduce the TV's start-up time after turning on the power with the remote control unit.

Selected item	Description
On	The TV quickly starts up from standby, 8.5 W or more of power consumption is required during standby.
Off	Power consumption is less than 1 W.

Language

Select from among 10 languages: English, Simplified Chinese, Arabic, French, Portuguese, Russian, Persian, Thai, Vietnamese and Indonesian.

Text language

Select from among 3 kinds of language: West Europe, Arabic, Farsi.

NOTE

- Teletext can display only when it is sent by a network. Not used to convert between languages.

Identification

You can check the current version of the software on the screen.

Reset

If complex adjustments are made and the settings cannot be restored to normal, you can reset the settings to the factory preset values.

NOTE

- If you execute "Reset", all the settings such as Picture, Audio and Programme will be reset to the factory preset values.

Option menu

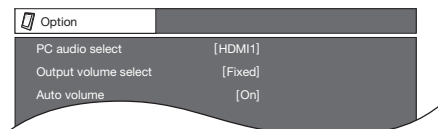

PC audio select

When using the PC terminal or HDMI1 terminal, you must select which terminal uses the AUDIO (R/L) jack for analogue audio input.

Selected item	Description
HDMI1	When connecting devices (including a PC) with DVI/HDMI cable to the HDMI 1 terminal and inputting analogue audio signals from the AUDIO (R/L) jack.
PC	When connecting a PC to the PC terminal, and inputting analogue audio signals from the AUDIO (R/L) jack.

Option menu (Continued)

NOTE

- For resetting all adjustment items to the factory preset values, press **▲/▼** to select "Reset", press **ENTER**, press **◀/▶** to select "Yes", and then press **ENTER**.
- Images may not be displayed properly depending on the settings and/or input signals.

Input signal

- Some input signals may have to be registered manually to display properly.
- The pairs of input signals (resolutions) in the list below are not distinguishable when received. In such case, you have to set the correct signal manually. After setting once, it will display when the same signal (resolution) is input again.

1280 × 768

1360 × 768

DivX (R) Reg. Code

Please see page 20.

Version up

This function is only for service personnel to use for software updates.

Picture and still image

You can freeze a motion picture on the Display.

- Press **FREEZE**.
 - A still image displays.
- Press **RETURN** again to exit still image.

NOTE

- The still image automatically goes out after 30 minutes.
- FREEZE** doesn't function for PC input (all resolution).

Wide Mode

Auto Selection

If you set "WSS" and "4:3 mode" in the Setup menu, the optimum WIDE mode is automatically chosen for every broadcast containing the WSS information.

"WSS" menu

To enable Auto Selection, set "WSS" in the Setup menu to "On". (See page 13.)

"4:3 mode" menu

To set the type of the wide screen, select "Panorama" or "Normal" in the 4:3 mode menu. (See page 13.)

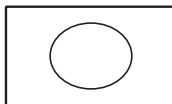

4:3 mode set to "Panorama"

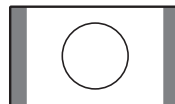

4:3 mode set to "Normal"

NOTE

- If the broadcast signal contains no WSS information, Auto Selection will not function even when the WSS option is enabled.

Game play time

This function displays the elapsed game time so you do not lose track of the time.

To display the elapsed time, select "GAME" under "AV mode" for the input mode of the terminal connected to the game console before starting the game.

Selected item	Description
On	The elapsed time is displayed every 30 minutes when you switch to GAME mode in external input mode.
Off	Hides the time.

Colour system

You can change the colour system to one that is compatible with the image on the screen. (Auto, PAL, SECAM, NTSC 3.58, NTSC 4.43, PAL-60)

NOTE

- If "Auto" is selected, colour system for each channel is automatically set. If an image does not display clearly, select another colour system (e.g. PAL, NTSC 4.43).
- "Colour system" is selectable only when inputting a composite signal.

Fine sync. (PC input mode only)

Adjusting the PC image automatically

Auto sync.

This function enables the screen to be automatically adjusted to its best possible condition when the analogue terminals of the TV and PC are connected with a commercially available RGB cable, etc.

NOTE

- Auto sync. is likely to succeed when an input PC image has wide vertical stripes (e.g. pattern with high contrast stripes, or cross-hatched). It may fail when an input PC image is solid (low contrast).
- Be sure to connect the PC to the TV and switch it on before starting Auto sync.

Adjusting the PC image manually

Ordinarily you can easily adjust the picture as necessary to change image position using Auto sync. In some cases, however, manual adjustment is needed to optimise the image.

Selected item	Description
H-Position	Centres the image by moving it to the left or right.
V-Position	Centres the image by moving it up or down.
Clock	Adjusts when the image flickers with vertical stripes.
Phase	Adjusts when characters have low contrast or when the image flickers.

Wide Mode (Continued)

Manual Selection

You can select different picture sizes that account for the kind of each picture.

- 1 Press **WIDE**.
 - The WIDE MODE menu displays.
 - The menu lists the wide mode options selectable for the type of video signal currently received.
- 2 Press **WIDE** or **▲/▼** while the WIDE MODE menu displays on the screen.
 - As you toggle down the options, each mode is immediately reflected on the TV.

Selected item	Description
Normal	For 4:3 "standard" pictures. A side bar appears on each side.
Zoom 14:9	For 14:9 letterbox pictures. A thin side bar appears on each side, and you may also see bars on the top and bottom with some programmes.
Panorama	In this mode the picture is progressively stretched toward each side of the screen.
Full	For 16:9 squeeze pictures.
Cinema 16:9	For 16:9 letterbox pictures. Bars may appear on the top and bottom with some programmes.
Cinema 14:9	For 14:9 letterbox pictures. Bars may appear on the top and bottom with some programmes.
Dot by Dot	Displays an image with the same number of pixels on the screen (only when receiving a 1080i/1080p/SXGA/SXGA+ signal).
Underscan	Display with an Underscan image only when receiving a 720p signal. Display with the High-Definition image adjusted optimally. Noise may appear on the edge of the screen with some programmes.

NOTE

- Some picture sizes may not be displayable depending on the input signal.

Teletext function

What is Teletext?

Teletext broadcasts pages of information and entertainment to specially equipped television sets. News, weather reports, sports information, stock exchange prices and programme previews are among the many services available.

Turning on and off Teletext

- 1 Select a TV channel or external input source providing the Teletext programme.
- 2 Press **⏏** to display the Teletext.

- 3 Each time you press **⏏**, the screen switches as shown below.



NOTE

- If you select a programme with no Teletext signal, "No Teletext available." is displayed.

Button functions

Buttons	Description
CH (▲/▼)	Increase or decrease the page number.
Colour (Red/Green/Yellow/Blue)	You can select a group or block of pages displayed in the coloured brackets at the bottom of the screen by pressing the corresponding Colour (Red/Green/Yellow/Blue) on the remote control unit.
0 — 9	Directly select any page from 100 to 899 by using 0 — 9 .
⏏ (Top/Bottom/Full)	Switch the Teletext image to Top, Bottom or Full.
⏏ (Reveal hidden TELETEXT)	To reveal hidden information such as an answer to a quiz.
⏏ (Hold)	To stop updating Teletext pages automatically or release the hold mode.
⏏ (Subtitle for TELETEXT)	Display the subtitle during Teletext page. <ul style="list-style-type: none"> • Subtitle will not be displayed when the service does not contain subtitle information.
⏏ (Subpage)	Display the subpage during Teletext page.

PC compatibility chart

	Resolution	Horizontal Frequency	Vertical Frequency	VESA Standard
VGA	720 × 400	31.5 kHz	70 Hz	
	640 × 480	31.5 kHz	60 Hz	✓
SVGA	800 × 600	37.9 kHz	60 Hz	✓
XGA	1024 × 768	48.4 kHz	60 Hz	✓
WXGA	1360 × 768	47.7 kHz	60 Hz	✓
SXGA	1280 × 1024	64.0 kHz	60 Hz	✓
SXGA+	1400 × 1050	65.3 kHz	60 Hz	✓

Power Management is a registered trademark of Sun Microsystems, Inc.
VGA and XGA are registered trademarks of International Business Machines Corp.

USB media player

■ Connecting a USB device

Connect a USB device to the TV as shown below.

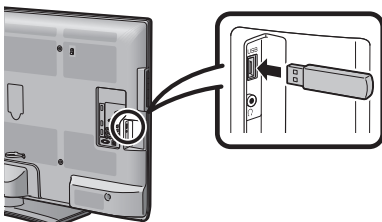

- The TV automatically switches to the USB mode when a USB device is inserted in the USB terminal.
- Depending on the USB device, the TV may not be able to recognise the contained data.
- Use only alphanumeric characters for naming files.
- File names over 80 characters (may vary depending on character set) may not be displayed.
- Do not disconnect a USB device or memory card from the TV while transferring files, when a screen is switching to another or before you exit "USB" mode.
- Do not connect and disconnect a USB device from the TV repeatedly.

⚠ CAUTION

- Do not use a USB extension cable when connecting a USB device to the USB terminal of the TV.
- Using a USB extension cable may prevent the TV from performing correctly.

■ USB media

Press **INPUT** to select the "USB" mode or the TV automatically switches to the USB mode when a USB device is connected to the TV.

USB media

In this mode, you can enjoy viewing photos, listening to music and watching videos from external USB devices.

🔗 NOTE

- You cannot enter the USB mode when there is no USB device.
- "Wide mode" is fixed during "Photo mode", "Music mode" and "Movie mode".

Selecting modes



- 1 Press **◀▶** to select among "Photo mode", "Music mode" and "Movie mode".
- 2 Press **ENTER**.

■ **Movie mode**

- 1 Press ◀/▶ to select “Movie mode”, and then press **ENTER**.
- 2 Press ▲/▼ to select the desired folder or directory, and then press **ENTER**.
- 3 Press ▲/▼ to select the desired video.



Buttons for video mode

Buttons	Description
ENTER	When selecting a folder icon: Enter this directory. When selecting a video file: Display the video in full screen.
▲/▼ (Cursor)	Select a desired item.
◀/▶ (Cursor)	Page up/down.
RETURN	Return to the USB select mode.

Viewing video



Buttons for full screen display operation

Buttons	Description
ENTER	Play/Pause the video.
▲ (Cursor)	Go to the previous file.
▼ (Cursor)	Go to the next file.
▶ (Cursor)	The FWD speed changes every time you press ▶. After playing to the end, the player goes to the next file and starts to play.
◀ (Cursor)	The REW speed changes every time you press ◀. After going back to the beginning, the player starts to play the same file.
RETURN	Return to the video list screen.
B button	Reveal/hide the guide display.
R button	Each time you press R button on the remote control, the subtitle switches.
G button	Each time you press G button on the remote control, the mode switches.

Music mode

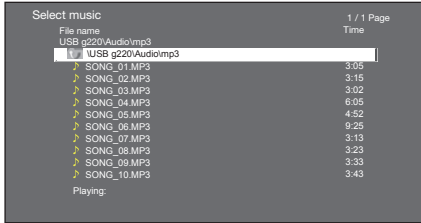

- 1 Press **◀/▶** to select “Music mode”, and then press **ENTER**.
- 2 Press **▲/▼** to select the desired folder, and then press **ENTER**.
- 3 Press **▲/▼** to select the desired music, and then press **ENTER**.

Buttons for music mode

Buttons	Description
ENTER	When selecting a folder icon: Enter this directory. When selecting a music file: Play the music.
▲/▼ (Cursor)	Select a desired item.
◀ (Cursor)	Page up.
▶ (Cursor)	Page down.
RETURN	Return to the USB select mode.
R button	Stop music.
G button	Play/Pause music.
B button	Audio only.

NOTE

- When there are invalid music files, the **✕** mark will be displayed for the file.
- The displayed play time may differ slightly from the actual play time depending on the files.

Photo mode

Viewing thumbnails

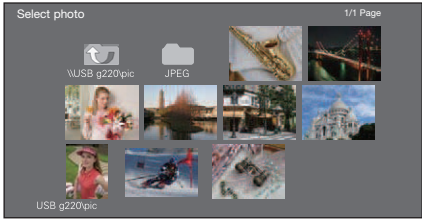

- 1 Press **◀/▶** to select “Photo mode”, and then press **ENTER**.
- 2 Press **▲/▼/◀/▶** to select the desired folder, and then press **ENTER**.
- 3 Press **▲/▼/◀/▶** to select the desired photo, and then press **ENTER**.

Buttons for thumbnail operations

Buttons	Description
ENTER	When selecting a folder icon: Enter this directory. When selecting a photo thumbnail: Display the photo in full screen.
▲/▼/◀/▶ (Cursor)	Select a desired item.
R button	Previous page.
G button	Next page.
Y button	Selecting BGM (Background music)
B button	Slide show.

NOTE

- When there are invalid photo files, the **✕** mark will be displayed for the file.
- You can see the file name, shooting date, file size and pixel size of the selected photo in the lower-left corner of the screen (shooting date is only available in the EXIF file format).

Viewing photos in full screen

Buttons for full screen display operation

Buttons	Description
◀/▶ (Cursor)	Go to the previous/next photo in the same directory.
RETURN	Return to the USB select mode.
R button	Rotate the photo by 90 degrees to the left.
G button	Rotate the photo by 90 degrees to the right.
B button	Reveal/hide the guide display.

NOTE

- Rotating photos only applies to the temporarily selected item and this setting is not saved.

■ DivX® setup

This is the function to confirm your registration code.

- 1 Press **MENU** and the MENU screen displays.
- 2 Press ◀/▶ to select “Option”.
- 3 Press ▲/▼ to select “DivX (R) Reg. Code”, and then press **ENTER**.
 - Copy the 10 digit code down.

DivX® VOD Code

You need to visit the DivX main page to register your TV. Please follow the online instruction to create DivX account and DivX registration video download.

Your registration is complete when you play the DivX registration video on TV.

DivX® Deactivate VOD Code

You can find the deregistration code (8~10 digit). Please use this code to deactivate on DivX website.

NOTE

- Visit www.DivX.com for more information about DivX® VOD.

■ List of files compatible with USB mode

USB device	USB Memory, USB card reader (Mass Storage class)
File system	FAT/FAT32/NTFS
Photo file format	JPEG (.jpg) (DCF2.0 compliant)
Music file format	MP3 (.mp3) Bitrate: 32 k, 40 k, 48 k, 56 k, 64 k, 80 k, 96 k, 112 k, 128 k, 160 k, 192 k, 224 k, 256 k, 320 kbps Sampling frequency: 32 k, 44.1 k, 48 kHz

Video file format		
File extension	Container	Video
*.avi	AVI	DivX 3.11/4/4.12/5.x/6 XviD H.264 MPEG2
*.mkv	MKV	H.264 MPEG2 MPEG1
*.mp4	MP4	DivX 3.11/4/4.12/5.x/6 XviD H.264
*.vob	VOB	MPEG2
.mpg/ .mpeg	PS	MPEG2 MPEG1
.rm/ .rmvb	RM	RM codec
.ts/ .trp/*tp	TS	H.264 MPEG2
*.divx	DivX	DivX 3.11/4/4.12/5.x/6
*.dat	DAT	MPEG2 MPEG1

NOTE

- Progressive format jpeg files are not supported.
- Files in USB 1.1 devices may not be played properly.
- Operation using USB hubs is not guaranteed.
- The compatibility of USB HDDs may not be guaranteed.
- Some video file formats may not be played depending on the file.
- Files may not be playable depending on the bitrate.

Appendix

Troubleshooting

The problems described below are not always caused by malfunctions. Check the TV again before having the TV serviced.

Problem	Possible Solution
• No power.	<ul style="list-style-type: none"> • Check if you pressed POWER on the remote control unit. (See page 8.) If the indicator on the TV lights up red, press POWER. • Is the AC cord disconnected? • Has the power been turned on? (See page 8.)
• Unit cannot be operated.	<ul style="list-style-type: none"> • External influences such as lightning, static electricity, etc., may cause improper operation. In this case, operate the unit after first turning the power off the TV or unplugging the AC cord and re-plugging it in after 1 or 2 minutes.
• Remote control unit does not operate.	<ul style="list-style-type: none"> • Is battery inserted with polarity (+, -) aligned? (See page 7.) • Is battery worn out? (Replace with new battery.) • Are you using it under strong or fluorescent lighting? • Is a fluorescent light shining on the remote control sensor?
• Picture is cut off.	<ul style="list-style-type: none"> • Is the image position correct? (See page 13.) • Are screen mode adjustments such as picture size made correctly? (See pages 13, 15 and 16.)
• Strange colour, light colour, or dark, or colour misalignment.	<ul style="list-style-type: none"> • Adjust the picture tone. (See page 11.) • Is the room too bright? The picture may look dark in a room that is too bright. • Check the colour system setting. (See pages 10, 15.) • Check the input signal setting. (See page 15.) • Check the HDMI auto view setting. (See page 13.)
• Power is suddenly turned off.	<ul style="list-style-type: none"> • The unit's internal temperature has increased. Remove any objects blocking the vent or clean. • Check the ECO setting. (See page 12.) • Is the sleep timer set? (See page 7.)
• No picture.	<ul style="list-style-type: none"> • Is the connection to external equipment correct? (See page 6.) • Has the input signal setup been performed correctly after connection? (See page 15) • Is the picture adjustment correct? (See page 11.) • Is the antenna connected properly? (See page 5.) • Is "On" selected in "Audio only"? (See page 14.)
• No sound.	<ul style="list-style-type: none"> • Is the volume too low? (See page 7.)
• The TV sometimes makes a cracking sound.	<ul style="list-style-type: none"> • This is not a malfunction. This happens when the cabinet slightly expands and contracts according to changes in temperature. This does not affect the TV's performance.

Cautions regarding use in high and low temperature environments

- When the unit is used in a low temperature space (e.g. room, office), the picture may leave trails or appear slightly delayed. This is not a malfunction, and the unit will recover when the temperature returns to normal.
- Do not leave the unit in a hot or cold location. Also, do not leave the unit in a location exposed to direct sunlight or near a heater, as this may cause the cabinet to deform and the LCD panel to malfunction.
Storage temperature: -20°C to +60°C.

Clearing the password

- 1 Repeat steps 1 to 2 in **Setting a password**. (See page 13.)
- 2 The password input screen displays.
- 3 If you enter "3001" using **0 - 9**, the "Child lock" setting menu will be displayed.
- 4 Enter the 4-digit number as a password using **0 - 9**. The new password is now set.

Specifications

Item		Model	LC-40LE530M	LC-46LE530M	LC-60LE630M
LCD panel			40" (1016 mm) UV2A & BLACK TFT LCD	46" (1168 mm) UV2A & BLACK TFT LCD	60" (1525 mm) UV2A & BLACK TFT LCD
Resolution			2,073,600 pixels (1920 × 1080)		
Video colour system			PAL/SECAM/NTSC 3.58/NTSC 4.43/PAL 60		
TV function	TV-standard		PAL: B/G, D/K, I SECAM: B/G, D/K, K/K _i NTSC: M		
	Receiving channel	VHF/UHF	44.25 — 863.25 MHz		
		CATV	S1 — S41ch (including Hyperband)		
	TV-tuning system		Auto Preset 99 ch		
		STEREO/BILINGUAL	NICAM: B/G, I, D/K A2 stereo: B/G		
Viewing angles			H : 176° V : 176°		
Audio amplifier			10 W × 2		
Speakers			3.4 × 15 cm 2pcs		3.2 × 15 cm 2pcs
Terminals	Antenna input		UHF/VHF 75 Ω DIN type		
	HDMI 1		HDMI (HDMI input) (480I, 576I, 480P, 576P, 720P/50Hz, 720P/60Hz, 1080I/50Hz, 1080I/60Hz, 1080P/50Hz, 1080P/60Hz, 1080P/24Hz), AUDIO in (common use with PC) (φ 3.5 mm jack)		
	HDMI 2		HDMI (HDMI input) (480I, 576I, 480P, 576P, 720P/50Hz, 720P/60Hz, 1080I/50Hz, 1080I/60Hz, 1080P/50Hz, 1080P/60Hz, 1080P/24Hz)		
	HDMI 3				
	INPUT 4		VIDEO in, AUDIO in		
	INPUT 5		VIDEO in, AUDIO in		
	INPUT 6		AUDIO in, COMPONENT in (480I, 576I, 480P, 576P, 720P/50Hz, 720P/60Hz, 1080I/50Hz, 1080I/60Hz)		
	AUDIO OUT		Audio out		
	AUDIO IN (R/L) (HDMI1/PC)		Ø 3.5 mm jack*		
	PC		15 pin mini D-sub, AUDIO in (common use with HDMI 1) (φ 3.5 mm jack)		
	USB		USB		
	RS-232C		9 pin D-sub male connector		
	DIGITAL AUDIO OUTPUT		Optical Digital Audio Output		
	Headphones		φ 3.5 mm jack		
OSD language			English/Simplified Chinese/Arabic/French/Portuguese/Russian/Persian/Thai/Vietnamese/Indonesian		
Power requirement			AC 110 — 240 V, 50/60 Hz		
Power consumption			97 W (0.5 W Standby)	116 W (0.5 W Standby)	190 W (0.5 W Standby)
Dimensions	without stand (mm)		959 (W) × 605 (H) × 89 (D)	1093 (W) × 682 (H) × 89 (D)	1383 (W) × 838 (H) × 72 (D)
	with stand (mm)		959 (W) × 642 (H) × 257 (D)	1093 (W) × 719 (H) × 293 (D)	1383 (W) × 871 (H) × 333 (D)
Weight without stand (with stand)			14 kg (16.5 kg)	19 kg (22.5 kg)	29.5 kg (32.5 kg)
Operating Temperature			0°C — 40°C		

* The HDMI1 and PC terminals can both use the same audio input terminal.

- As a part of policy of continuous improvement, SHARP reserves the right to make design and specification changes for product improvement without prior notice. The performance specification figures indicated are nominal values of production units. There may be some deviations from these values in individual units.

Optional accessory

- Additional optional accessories may be available in the near future. When purchasing, please read the newest catalogue for compatibility and check the availability.

Part name	Model number
Wall mount bracket (for LC-40LE530M)	AN-37AG2+ AN-37P30
Wall mount bracket (for LC-46LE530M/LC-60LE630M)	AN-52AG4

CAUTION

- This TV should be mounted on the wall only with the listed wall mount bracket. The use of other wall mount brackets may result in an unstable installation and may cause serious injuries.
- Installing the Liquid Crystal Television requires special skill that should only be performed by qualified service personnel. Customers should not attempt to do the work themselves. SHARP bears no responsibility for improper mounting or mounting that results in accident or injury.
- Carefully read the instructions that come with the bracket before beginning work.

Removing the stand- 40/46LE530M

For wall mounting with the optional bracket (AN-52AG4 or AN-37AG2) remove the stand.

Before setting TV on the wall

- Remove the connected cables (DVD, VCR, etc) from the terminals.
- Detach the four caps at the 4 locations on the rear of the TV.

- 1 Unfasten the screw at the location on the rear of the stand cover and remove the stand cover.

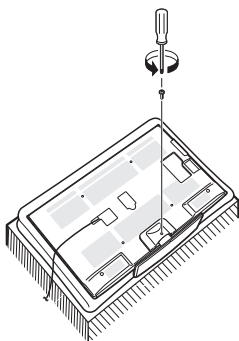

- 2
 - ① Unfasten the screws at the 3 or 4 locations on the stand.
 - ② Detach the stand from the TV.

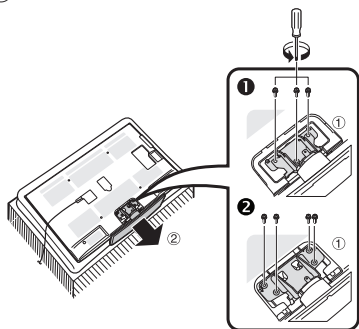

① 40 inch models

② 46 inch models

NOTE

- To attach the stand, perform the above steps in reverse order.
- As the TV is very heavy, be careful when moving it.

Removing the stand- 60LE630M

For wall mounting with the optional bracket (AN-52AG4) remove the stand.

Before setting TV on the wall

- Remove the connected cables (DVD, VCR, etc) from the terminals.
- Detach the four caps at the 4 locations on the rear of the TV.

- 1 Unfasten the screws at the 4 locations on the rear of the stand.

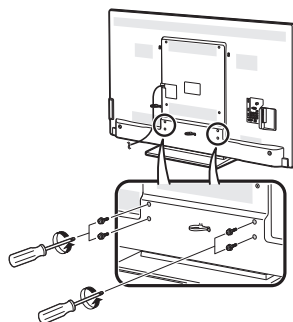

- 2 Detach the stand from the TV (hold the stand so it will not drop from the edge of the base area).

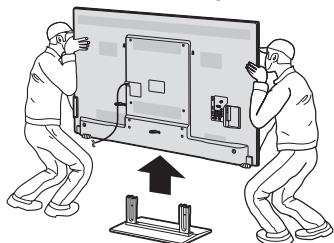

NOTE

- To attach the stand, perform the above steps in reverse order.
- As the TV is very heavy, be careful when moving it.

Mounting the TV on a wall

To use this TV mounted on a wall, remove the AC cord holder and the screws at the 4 locations on the rear of the TV, and then use the screws supplied with the wall mount bracket to secure the bracket to the rear of the TV.

Only for LC-46LE530M

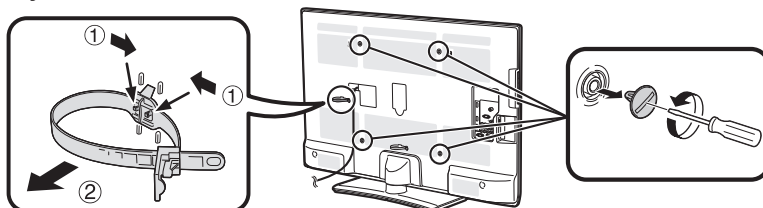

- This TV should be mounted on a wall only with the wall mount bracket and attachment* available from SHARP (See page 22). The use of other wall mount brackets may result in an unstable installation and may cause serious injuries.
- Mounting the LCD colour TV requires special skills and should only be performed by qualified service personnel. Customers should not attempt to do the work themselves. SHARP bears no responsibility for improper mounting or mounting that results in accident or injury.
- You can ask qualified service personnel about using an optional bracket and attachment* to mount the TV to a wall.
- When you mount the TV on a wall, you should attach the supporting post.
- Detach the AC cord holder on the rear of the TV before mounting the TV on a wall.

* Only for 40 inch models

Hanging on the wall

AN-52AG4 or AN-37AG2 wall mount bracket
(see the bracket instructions for details).

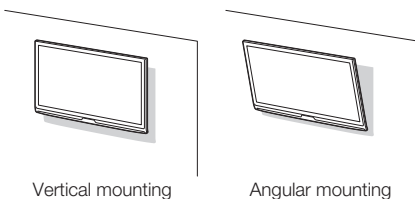

About setting the TV angle

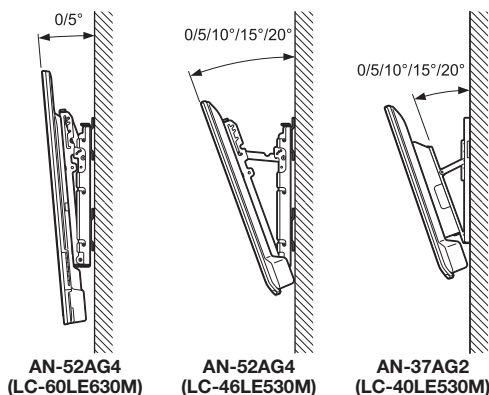



พิมพ์ในประเทศไทย
Printed in Malaysia
TINS-F212WJZZ
11P07-MA-NG